

- Fixing Notes:**
- 1) The Fixed Point Clip Must Be Slid Onto the Rail Before the Sliding Clip.
 - 2) This Allows the Fixed Point Clip To Be Positioned And Secured Before The Sliding Clip Is Fixed To The Top Of The Rail.

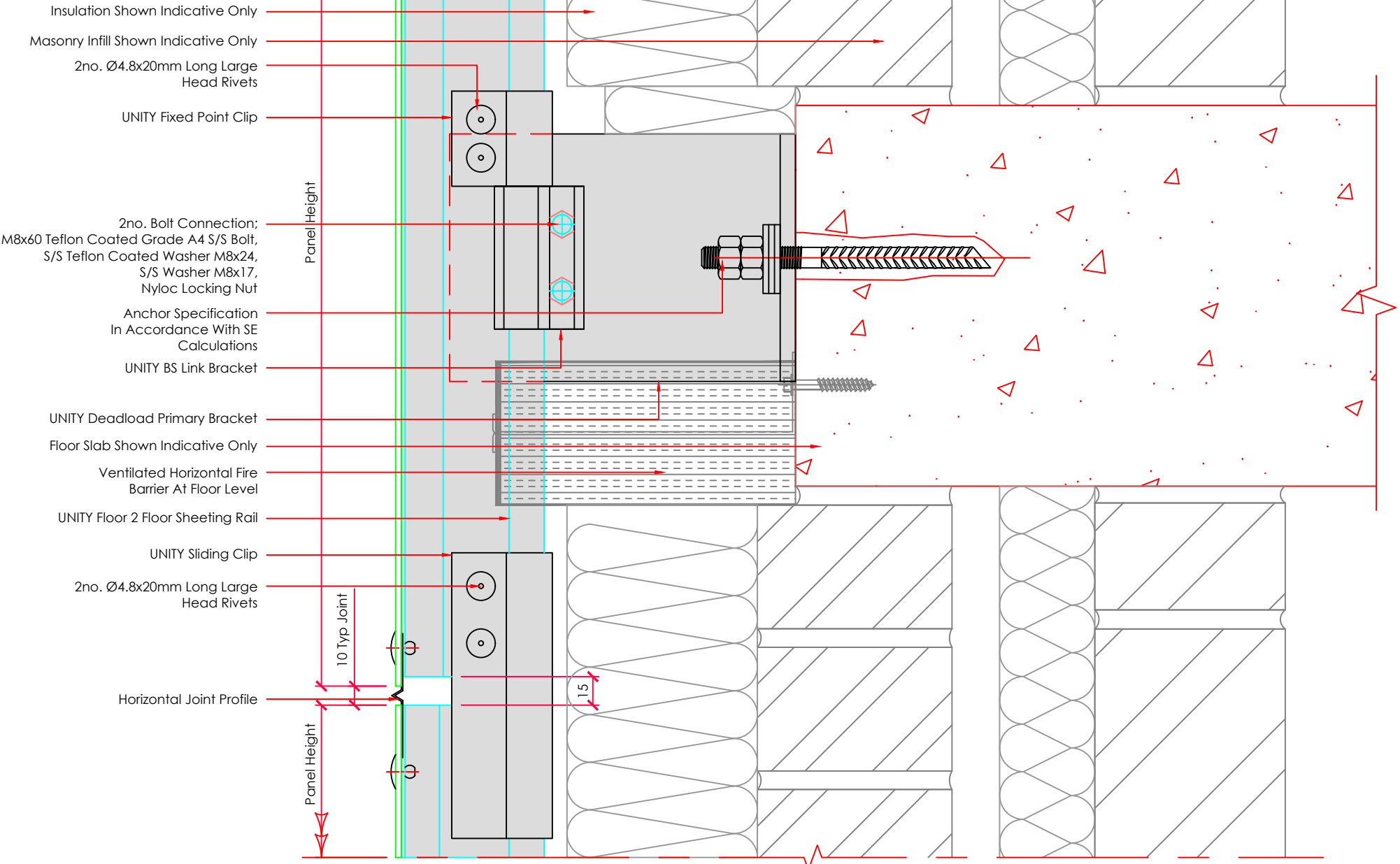

METALLINE
ARCHITECTURAL FABRICATIONS
Metalline Architectural Fabrications
Hollies Park Road,
Cannock,
Staffordshire,
WS11 1DB
www.metalline.co.uk
Tel: +44 (0) 1543 456930

DO NOT SCALE

1. ANY DOUBT OF THE CONTENTS OF THIS DRAWING PLEASE CONTACT THE DESIGN OFFICE
2. THIS DRAWING TO BE READ IN CONJUNCTION WITH ALL OTHER CONTRACT DRAWINGS.
3. DO NOT REPRODUCE THIS DRAWING (IN FULL OR PART) WITHOUT THE WRITTEN PERMISSION OF METALLINE (SERVICES) LTD
4. COPYRIGHT METALLINE (SERVICES) LTD 2020

UNITY
A1F2F
A Floor 2 Floor Rail System

DRAWING TITLE		-	-	-	-	-
UNITY A1 FLOOR 2 FLOOR SYSTEM DEAD LOAD DETAIL 1 (VERTICAL)		-	-	-	-	-
DATE 20/07/20	SCALE 1:2.5 @A3	-	-	-	-	-
DRAWN CB	CHECKED -	-	-	-	-	-
DRAWING No. 204	REVISION -	REV	BY	DESCRIPTION	DATE	CHKD