

TOP OF PANEL IS A RESTRAINT FIXING (THE DEAD FIXING IS TO THE BOTTOM OF THE PANEL). THEREFORE, THE JOINT ALLOWS FOR EXPANSION/CONTRACTION

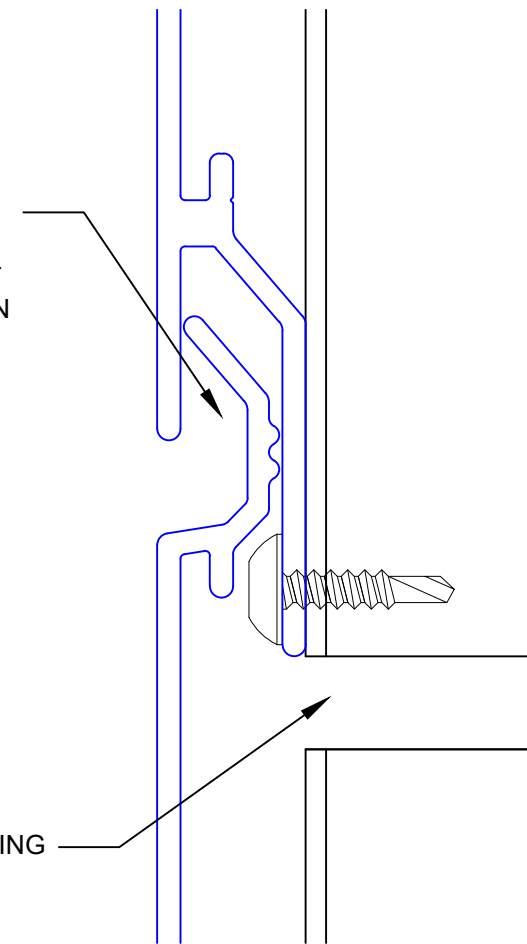

MOVEMENT JOINT BETWEEN FRAMING (TYPICALLY AT SLAB LEVEL)

DETAIL A

AVAILABLE WITH AN ANODISED FINISH (A1 CLASSIFICATION) OR POLYESTER POWDER COATED (A2-s1, d0 CLASSIFICATION)

**UNITY X-TRU
TYPICAL HORIZONTAL MOVEMENT JOINT
DETAIL**

VERTICAL AND HORIZONTAL FIRE BARRIERS TO SPECIALIST DESIGN

Metalline Architectural Fabrications
Hollies Park Road,
Cannock,
Staffordshire,
WS11 1DB
www.metalline.co.uk
Tel: +44 (0) 1543 456930



DO NOT SCALE

1. ANY DOUBT OF THE CONTENTS OF THIS DRAWING PLEASE CONTACT THE DESIGN OFFICE.
2. THIS DRAWING TO BE READ IN CONJUNCTION WITH ALL OTHER CONTRACT DRAWINGS.
3. DO NOT REPRODUCE THIS DRAWING (IN FULL OR PART) WITHOUT THE WRITTEN PERMISSION OF METALLINE (SERVICES) LTD
4. COPYRIGHT METALLINE (SERVICES) LTD 2020



DRAWING TITLE		-	-	-	-	-
UNITY X-TRU TYPICAL DETAILS HORIZONTAL MOVEMENT JOINT DETAIL		-	-	-	-	-
DATE	9/09/21	SCALE	NTS	-	-	-
DRAWN	CB	CHECKED		-	-	-
DRAWING No.	ML-XTRU-D06	REVISION		REV	BY	DESCRIPTION
						DATE
						CHKD