

AVAILABLE WITH AN ANODISED FINISH (A1 CLASSIFICATION) OR POLYESTER POWDER COATED (A2-s1, d0 CLASSIFICATION)

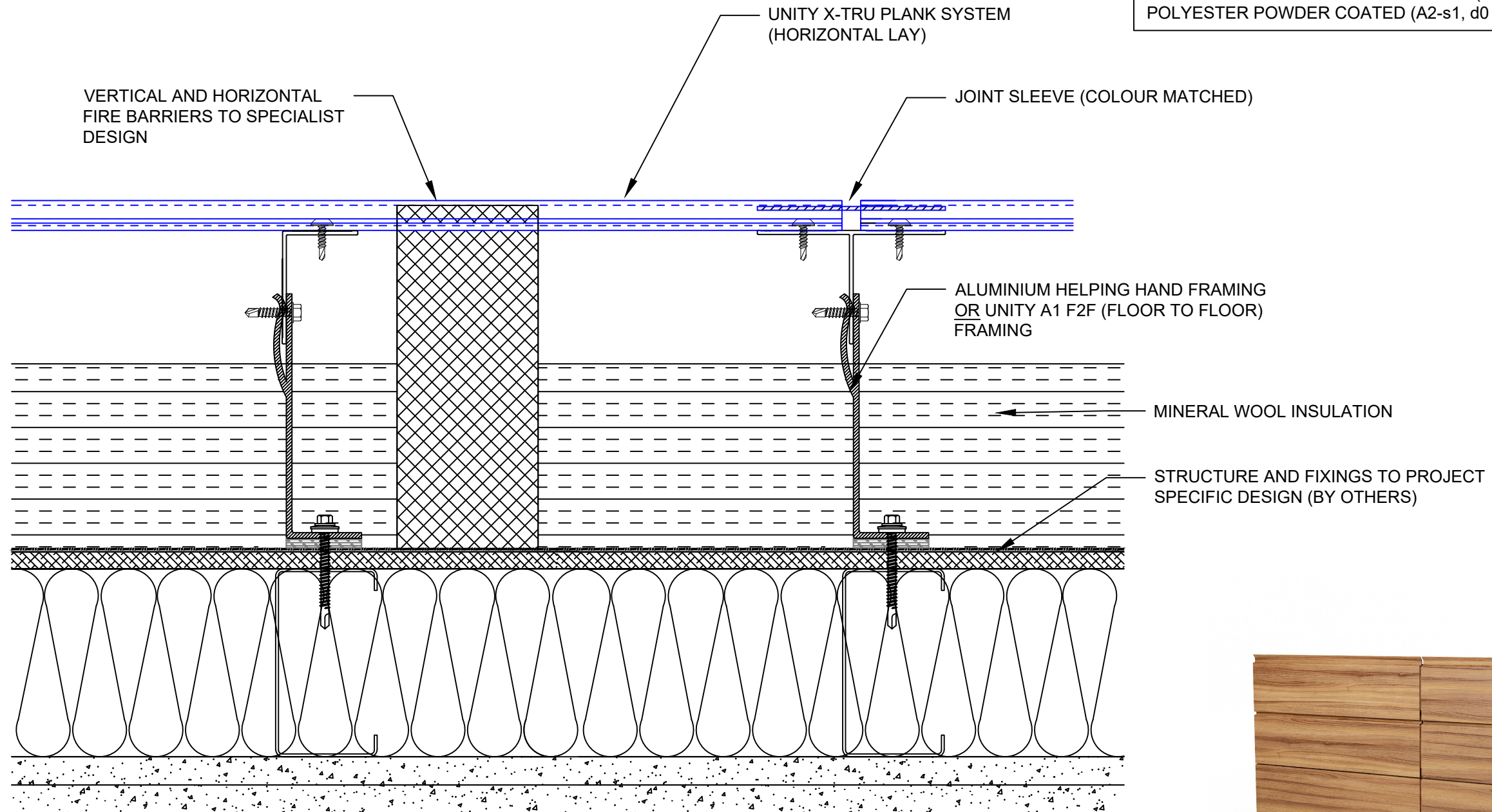

**UNITY X-TRU**  
**TYPICAL VERTICAL JOINT DETAIL**  
**(HORIZONTAL PLANK)**



Metalline Architectural Fabrications  
 Hollies Park Road,  
 Cannock,  
 Staffordshire,  
 WS11 1DB  
[www.metalline.co.uk](http://www.metalline.co.uk)  
 Tel: +44 (0) 1543 456930



**DO NOT SCALE**

1. ANY DOUBT OF THE CONTENTS OF THIS DRAWING PLEASE CONTACT THE DESIGN OFFICE.
2. THIS DRAWING TO BE READ IN CONJUNCTION WITH ALL OTHER CONTRACT DRAWINGS.
3. DO NOT REPRODUCE THIS DRAWING (IN FULL OR PART) WITHOUT THE WRITTEN PERMISSION OF METALLINE (SERVICES) LTD
4. COPYRIGHT METALLINE (SERVICES) LTD 2020



DRAWING TITLE		-	-	-	-	-
UNITY X-TRU TYPICAL DETAILS HORIZONTAL PLANK VERTICAL JOINT DETAIL		-	-	-	-	-
DATE	9/09/21	SCALE	NTS	-	-	-
DRAWN	CB	CHECKED	-	-	-	-
DRAWING No.	ML-XTRU-D01	REVISION	REV	BY	DESCRIPTION	DATE
						CHKD